

DS-2CD802/812P(N)F-E(W) Network Box Camera

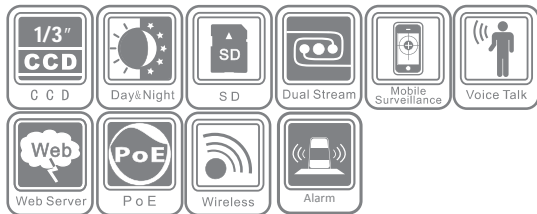

Key features

- High performance Sony CCD
- H.264 / MPEG4 dual stream video compression
- Support 32 GB SD/SDHC card local storage
- Day / night auto switch

Dimensions

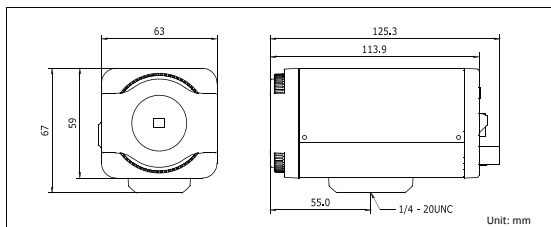

Accessories



Specifications

	DS-2CD802P(N)F-E(W)	DS-2CD812P(N)F-E(W)
Camera		
Image sensor	1/3" Sony CCD	
Signal system	PAL / NTSC	
Min. illumination	0.1 lux@F1.2, ACG on	
Shutter time	1/50 (1/60)s ~ 1/100,000s	
Lens mount	C/CS mount	
Auto iris	DC/Video	
Day & night	Electronic	
Horizontal resolution	420 TVL	480 TVL
Compression standard		
Video compression	H.264 (MPEG-4 optional)	
Bit rate	32 Kbps ~ 8 Mbps	
Audio compression	OggVorbis	
Dual stream	Yes	
Image		
Max. image resolution	PAL: 704 × 576 NTSC: 704 × 480	
Frame rate	50 HZ: 25 fps (704 × 576) 60 HZ: 30 fps (704 × 480)	
Image settings	Saturation, brightness, contrast adjustable through client software or web browser	
Network		
Alarm Trigger	Motion detection	
Protocols	TCP/IP, HTTP, DHCP, DNS, RTP/RTSP, PPPoE (FTP, SMTP, NTP, SNMP optional)	
Security	Password protection	
Security	Password protection, Watermark	
Interface		
Audio input	1-ch, 3.5 mm audio interface (2.0 - 2.4 Vp-p, 1 kΩ)	
Audio output	1-ch, 3.5 mm audio interface (line level, 600 Ω)	
Communication interface	1 RJ45 10M / 100M ethernet port and 1 RS-485 interface	
Alarm input	1	
Alarm output	1	
Video output	1 Vp-p composite output (75 Ω / BNC)	
Local storage	Built-in SD/SDHC slot, up to 32 GB	
Reset button	Yes	
General		
Operating conditions	-10°C ~ 60°C (14°F ~ 140°F) Humidity 90% or less (non-condensing)	
Power supply	12 VDC ± 10%, PoE (802.3af)	
Power consumption	4W max. -W: 5.5W max.	
Dimensions	63 x 67 x 125 mm (2.48" x 2.64" x 4.92")	
Weight	650g (1.43 lbs)	

Available models

DS-2CD802PF-E, DS-2CD802PF-W, DS-2CD812PF, DS-2CD812PF-E, DS-2CD812PF-W
DS-2CD802NF-E, DS-2CD802NF-W, DS-2CD812NF, DS-2CD812NF-E, DS-2CD812NF-W