

## DS-2CC1173P-VF(IR) Weather-proof IR Bullet Camera

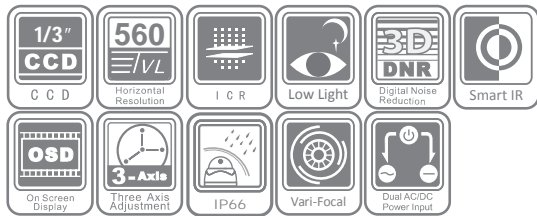

### Key Features

- 1/3" Sony Super HAD CCD II
- Low illumination
- True day / night
- 3-axis adjustment
- 3D digital noise reduction
- IP66 rating

### Dimensions

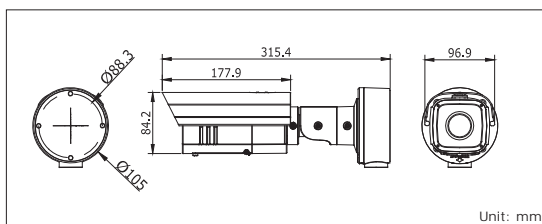

### Specifications

DS-2CC1173P-VF(IR)	
<b>Camera</b>	
Image sensor	1/3" Sony Super HAD CCD II
Signal system	PAL
Effective pixels	752 (H) × 582 (V)
Min. illumination	Color: 0.1 lux@F1.2, AGC on, 0.0003 lux@F1.2, AGC on, sens-up × 256 Color: 0.14 lux@F1.4, AGC on, 0.0004 lux@F1.4, AGC on, sens-up × 256 B/W: 0.01 lux@F1.2, AGC on, 0.00003 lux@F1.2, AGC on, sens-up × 256 B/W: 0.014 lux@F1.4, AGC on, 0.00004 lux@F1.4, AGC on, sens-up × 256 -IR: 0.1 lux@F1.2, AGC on, 0.0003 lux@F1.2, AGC on, sens-up × 256, 0 lux with IR 0.14 lux@F1.4, AGC on, 0.0004 lux@F1.4, AGC on, sens-up × 256), 0 lux with IR
Shutter time	1/50s ~ 1/100,000s
Lens	2.8 ~ 12mm @F1.4 Angle of view: 92 ~ 27.2°
Lens mount	φ 14
Auto iris	DC drive
Angle adjustment	Pan: 0 ~ 360°, tilt: 0 ~ 90°, rotation: 0 ~ 360°
Day & night	IR cut filter with auto switch
Horizontal resolution	Color: 560 TVL, B/W: 600 TVL
Synchronization	Internal / power synchronization
Video output	1Vp-p composite output (75 Ω / BNC) Test monitor out [1Vp-p composite output (75 Ω / BNC), device line]
S/N ratio	More than 52 dB
<b>Menu</b>	
Camera ID	On / off (15 letters, adjusted position)
Auto gain control	Low / middle / high / off
D/N mode	Auto / day / night
Auto white balance	Auto trace WB1 / auto trace WB2 / manual / auto control
Privacy mask	On / off, maximum 8 zones
Motion detection	On / off
BLC	Area / value / off
Eclipse	On / off
Digital WDR	Indoor / outdoor / off
Anti-flicker	On / off
Language	English / Chinese
Video	SMART IR, digital WDR, excessive high light compensation, gamma correction, digital zoom, digital noise reduction, POS / NEG ,mirror, sharpness, Y, C, blemish detection
<b>General</b>	
Operating conditions	-10°C ~ 60°C (14°F ~ 140°F) Humidity 90% or less (non-condensing)
Power supply	24 VAC ± 10%, 12 VDC ± 10%
Weather-proof rating	IP66
IR range	-IR: approx. 20 ~ 30 meters
Power consumption	3.5W max. -IR: 10W max.
Dimensions	97 x 87 x 314mm (3.82" × 3.42" × 12.36")
Weight	2100g (4.62 lbs)

### Available models

DS-2CC1173P-VF, DS-2CC1173P- VFIR